



*(Knowledge for Development)*

## **KIBABII UNIVERSITY**

### **UNIVERSITY EXAMINATIONS 2020/2021 ACADEMIC YEAR**

### **SPECIAL / SUPPLEMENTARY EXAMINATIONS YEAR ONE SEMESTER TWO EXAMINATIONS**

### **FOR THE DEGREE OF BACHELOR OF SCIENCE COMPUTER SCIENCE**

**COURSE CODE** : **CSC 124**  
**COURSE TITLE** : **INTRODUCTION TO COMPUTING  
ESSENTIALS II**

**DATE:** 30 /09/2021      **TIME:** 08:00 A.M – 10:00 A.M

---

#### **INSTRUCTIONS TO CANDIDATES**

**ANSWER QUESTIONS ONE AND ANY OTHER TWO.**

**QUESTION ONE [COMPULSORY] [30 MARKS]**

- a) i. All the open applications in windows are available on the \_\_\_\_\_ [1 mark]
- ii. The rectangular area displaying content independently of other areas of the screen is \_\_\_\_\_ [1 mark]
- iii. The \_\_\_\_\_ is also the handle for the window. [1 mark]
- iv. The \_\_\_\_\_ provides such information as current page number, words in a doc, etc. [1 mark]
- v. \_\_\_\_\_ a document gives a hard copy of the text. [1 mark]
- vi. To select a whole sentence you \_\_\_\_\_ [1 mark]
- vii. Spreadsheet displays data in the form of \_\_\_\_\_ and \_\_\_\_\_ [1 mark]
- viii. In excel a single workbook can contain up to a maximum of \_\_\_\_\_ worksheets. [1 mark]
- ix. The \_\_\_\_\_ displays the contents of the active cell [1 mark]
- x. An application that enables a user store, maintain, organize and retrieve data is \_\_\_\_\_ [1 mark]
- b. Detail five rules for naming files in Ms DOS. [5 marks]
- c. Describe what is a computer network. [2 marks]
- Give a description of three types of networks. [3 marks]
- d) Give five ways through which viruses are spread and explain the measures that can be taken to avoid spread of viruses. [5 marks]
- e) i. Give any six default items found on the computer desktop. [3 marks]
- ii. Explain the significance of the computer graphics software to a user. [2 marks]

## QUESTION TWO [20 MARKS]

- a) Describe five things a computer user can use the standard tool bar to do while preparing a power point business presentation [5 marks]
- b) Differentiate between outline tab and slides tab in PowerPoint. [4 marks]
- c) Name the parts marked A – K [1 mark each]

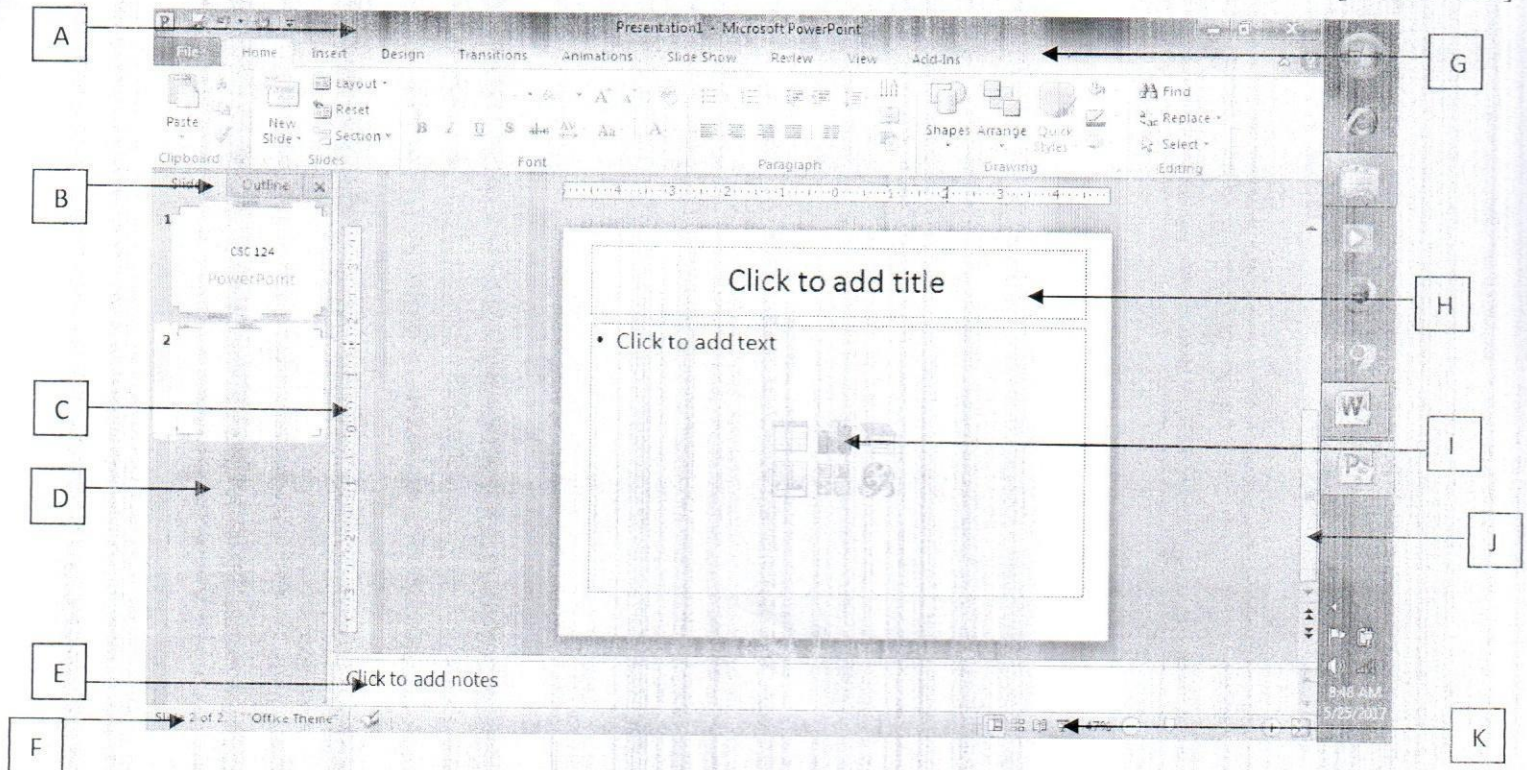

## QUESTION THREE: [20 MARKS]

- a) What is a spreadsheet? Of what importance is it in an office? [4 marks]
- b) Discuss five important features of Ms. Excel. [10 marks]
- c) MS- Excel evaluates the formula according to the order of precedence of the operators. Using a table, draw the correct order that Excel uses. [6 marks]

## QUESTION FOUR [20 MARKS]

- a) Fields in Ms Access accept certain types of data types. Describe such four types. [4 marks]
- b) Describe three ways a user can create tables in Ms Access. [6 marks]
- c) What advantages does a user connected to the internet have over one who's not connected. [5 marks]
- d) Explain modern challenges brought about by the internet today [5 marks]

### QUESTION FIVE [20 MARKS]

- a) Suppose the value of the cell B6 is 50125. Show how you will divide the value by 5 and have the results in the cell E6. [4 marks]
- b) word-processing is concerned with preparation of a document, describe six units of the document in details. [12 marks]
- c) Explain the following as used in Ms Word:
- i. Word Wrap
  - ii. Thesaurus
- [4 marks]